

CASEWOOD STUDIOS

LURIAN CHEST 3 DRAWER TRADITIONAL

FT-STB07-02-06-01 / FT-STB07-02-06-02

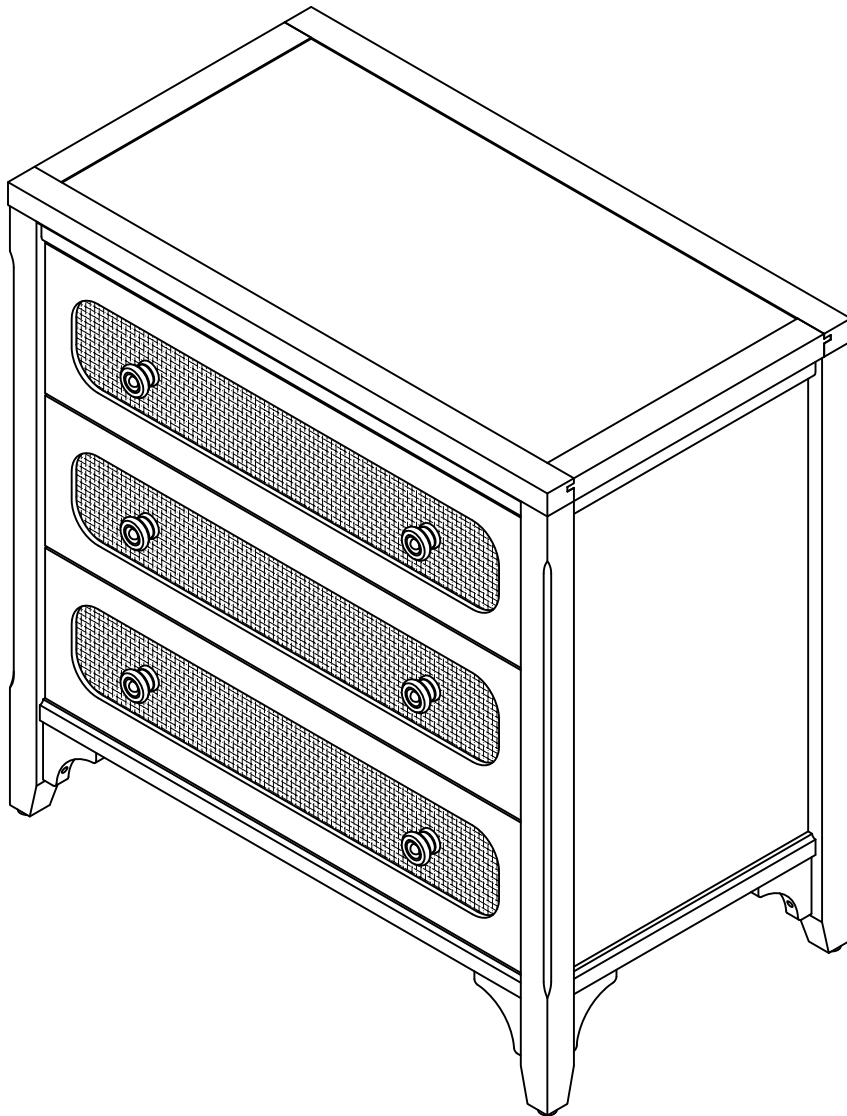

ASSEMBLY INSTRUCTIONS

Introduction

Please read all instructions first.

All you need to assemble your unit is a Phillips screwdriver.

Before you begin, take some time to check all parts against the hardware and parts list on the next pages.

Please place all parts on a soft cloth or carpet to prevent scratching during assembly.



To avoid collapse or injury, DO NOT sit, stand or climb on this unit. DO NOT stack heavy objects on this unit.
NEVER put a TV on this product.
NEVER allow children to climb or hang on drawers.

Care and Maintenance

Clean with a soft damp cloth.

Should a deep scratch or gouge occur, we recommend touch up with a matching paint or stain available in most hardware stores.

PARTS & HARDWARES

aa = 3 pcs +1 Extra Wood Screw Ø8x1 1/4"	bb = 2 pcs +1 Extra Wood Screw Ø6x1 1/4"	cc = 33 pcs +1 Extra Wood Screw 1 1/4"	dd = 18 pcs +1 Extra Wood Screw 3/4"
ee = 16 pcs +1 Extra Camlock Bolt	ff = 16 pcs +1 Extra Camlock	gg = 6 pcs Handle Bolt	hh = 6 pcs Handle
ii = 4 pcs +1 Extra Dowel	jj = 2 sets Safety Bracket Kit	Tool Required (Not Included)	

- A. TOP ASSEMBLY 1X
- B. LEFT ASSEMBLY 1X
- C. RIGHT ASSEMBLY 1X
- D. TOP RAIL 1X
- E. BOTTOM RAIL 1X
- F. UPPER BACK PANEL 1X
- G. LOWER BACK PANEL 1X
- H. DRAWER FRONT 3X
- I. DRAWER LEFT 3X
- J. DRAWER RIGHT 3X
- K. DRAWER BACK 3X
- L. DRAWER BASE 3X
- M. DRAWER SUPPORT 3X

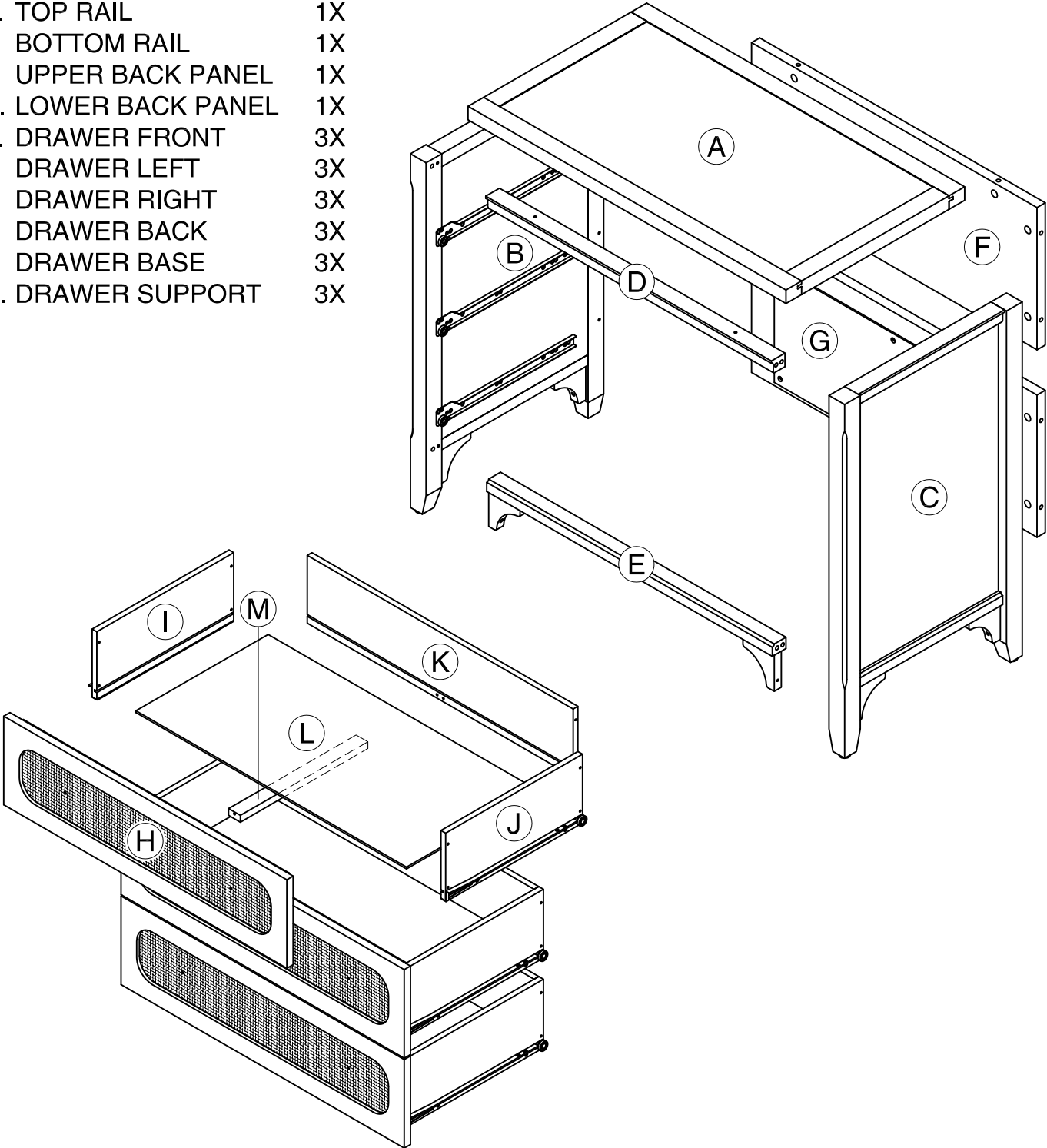

1

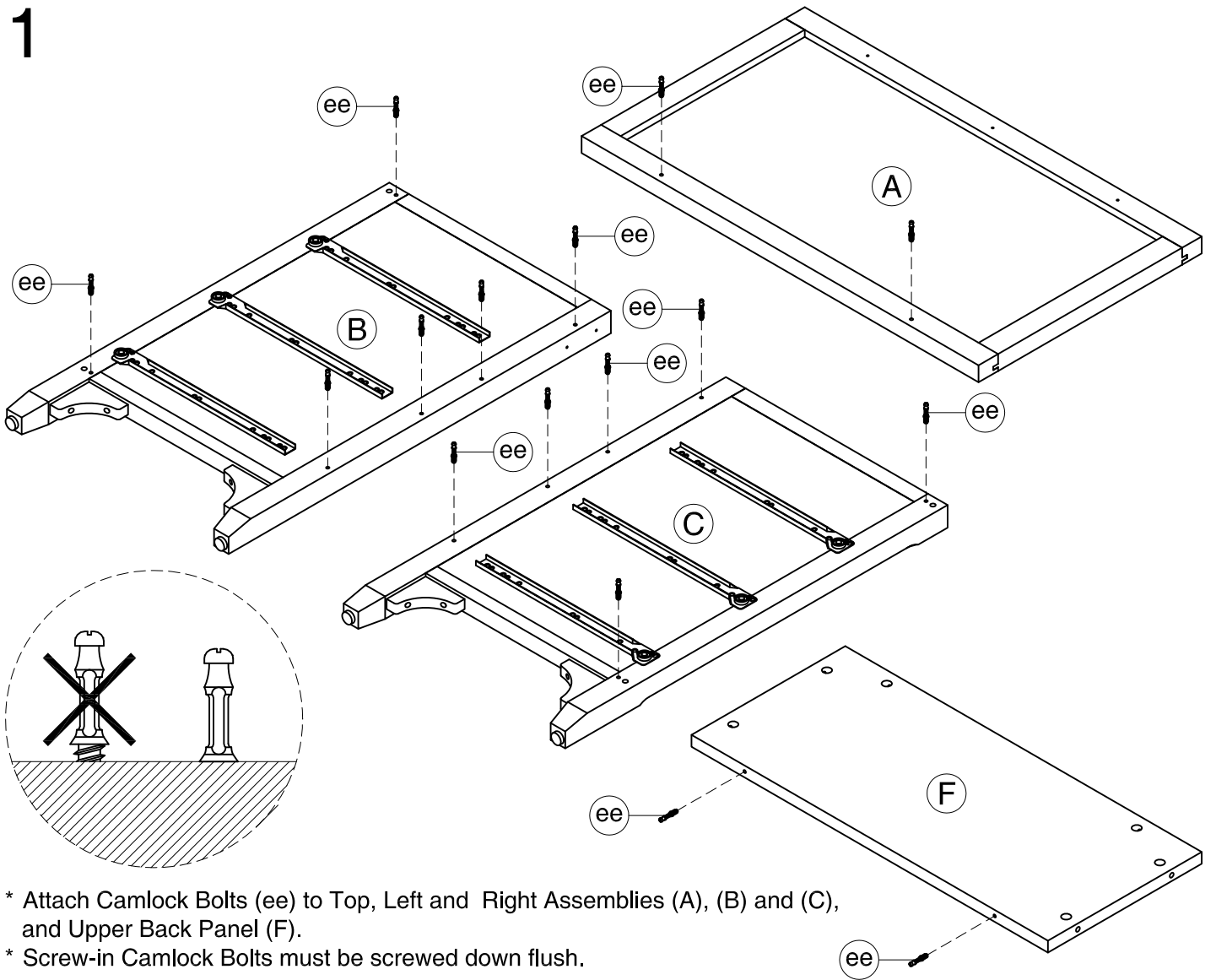

2

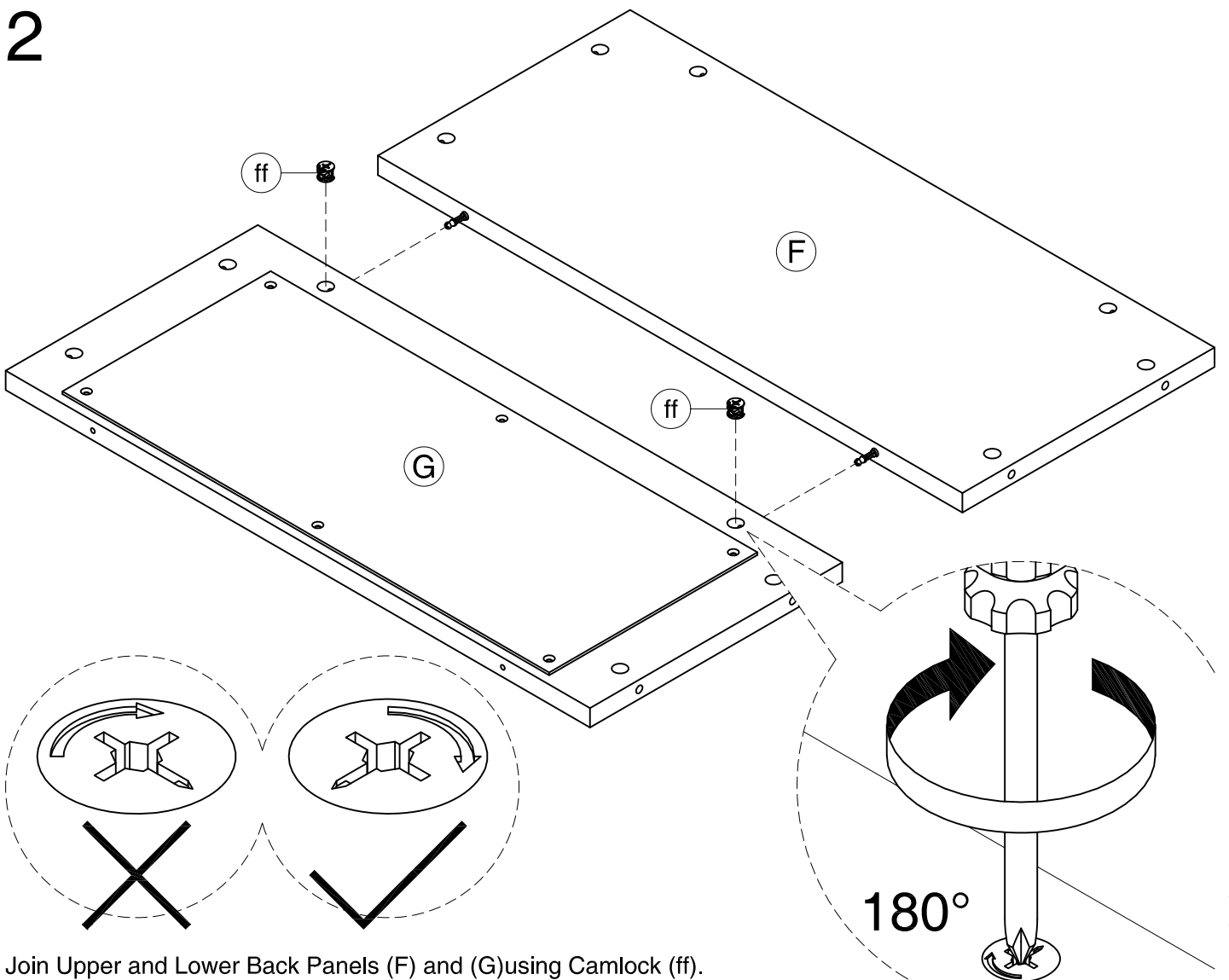

3

- * Attach Left and Right Assemblies (B) and (C) to Back Panel Assembly using Camlocks (ff).
- * Attach Left and Right Assemblies (B) and (C) to Top Rail (D) using Camlocks (ff) and Dowels (ii).
- * Attach Left and Right Assemblies (B) and (C) to Bottom Rail (E) using Wood Screws (bb), Camlocks (ff) and Dowels (ii).

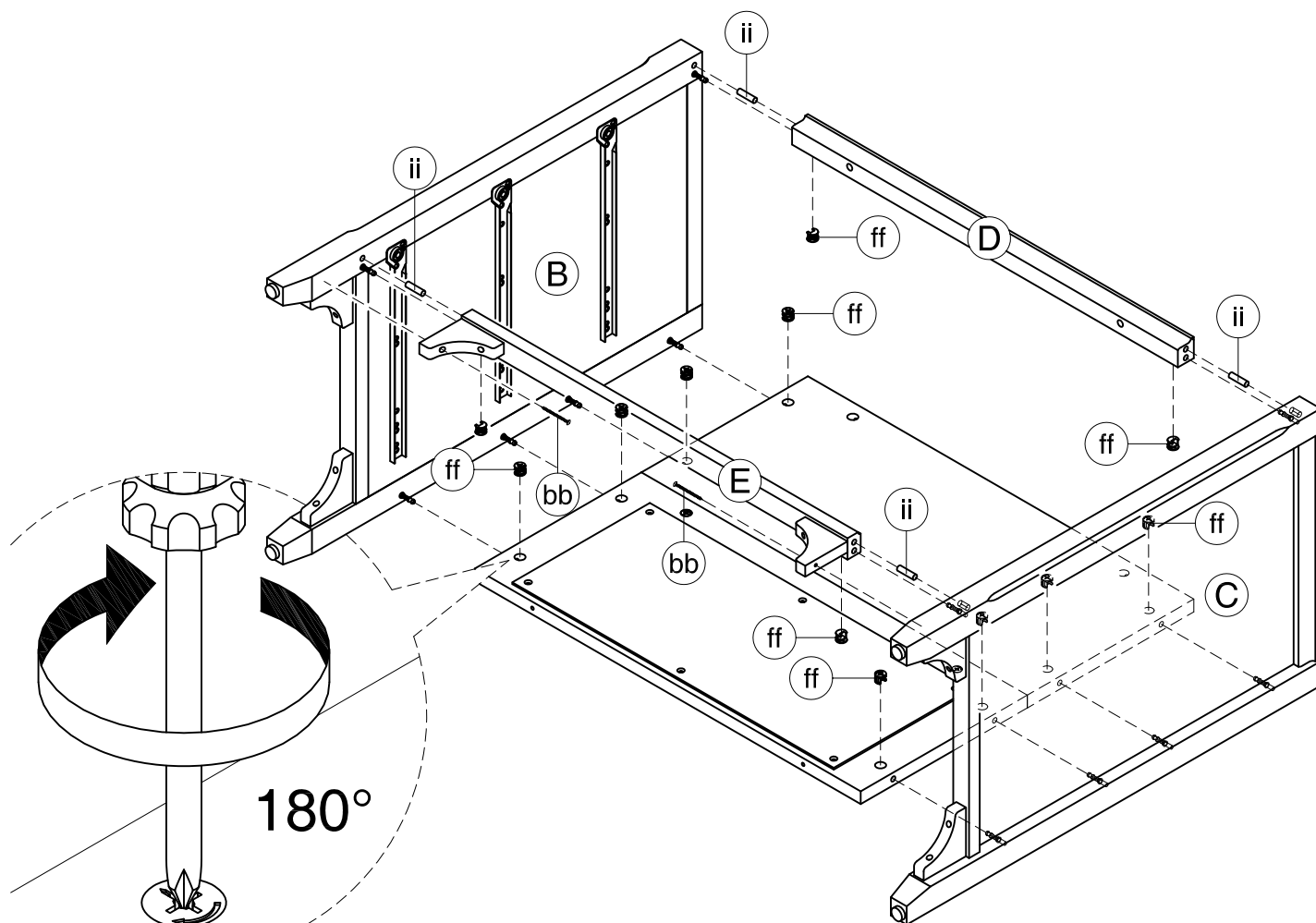

4

- Attach Top Assembly (A) to unit using Wood Screws (aa) and Camlocks (ff).

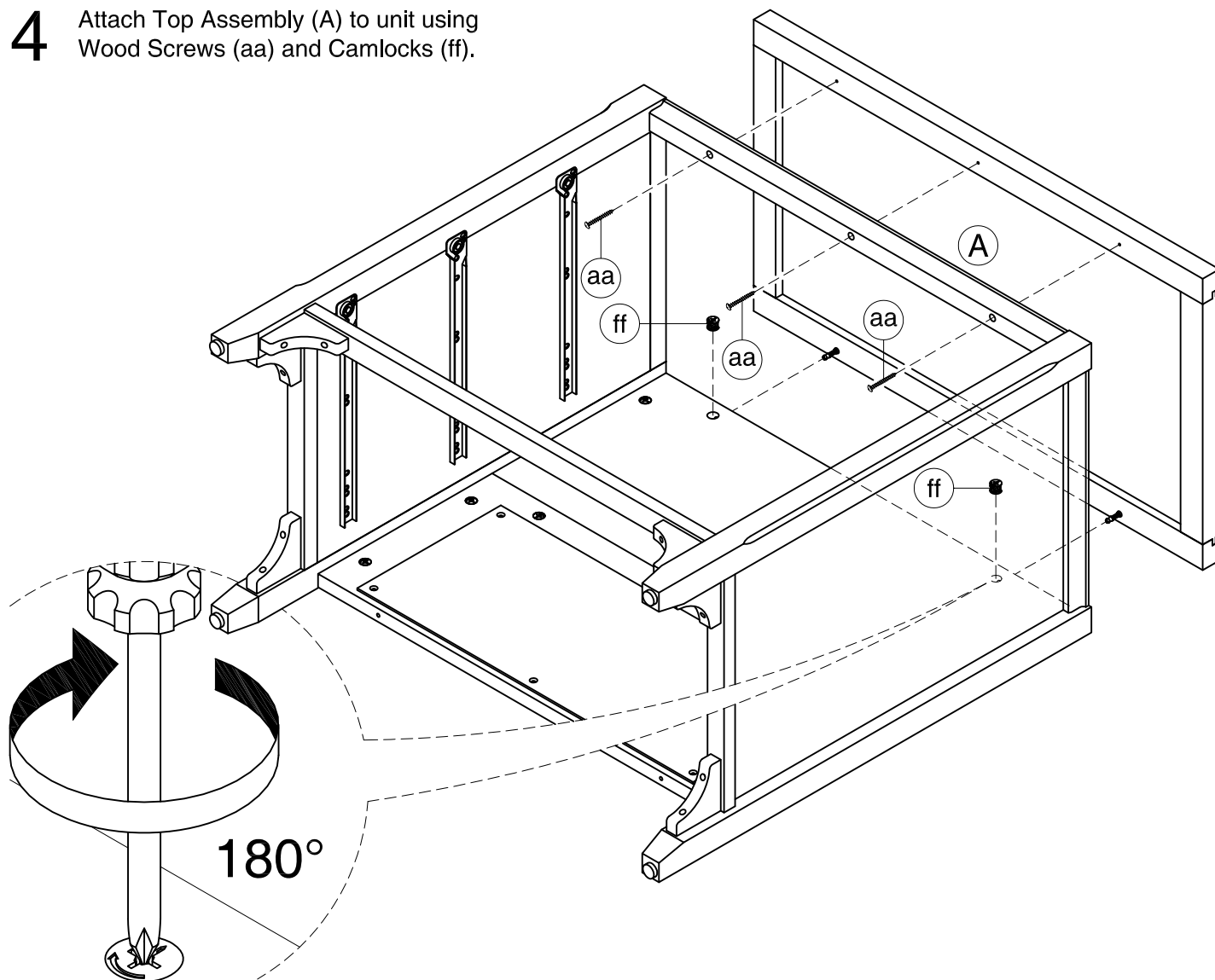

5

- * Attach Handle (hh) to Drawer Front (H) using Handle Bolt (gg).
- * Attach Drawer Left and Right (I) and (J) to Drawer Back (K) using Wood Screw (cc).
- * Slide Drawer Base (L) into the groove.
- * Attach Drawer Front (H) to Drawer Left and Right (I) and (J) using Wood Screw (cc).
- * Attach Drawer Support (M) to the bottom side of drawers using Wood Screw (cc).
- * Do the same step to the next drawers.
- * Slide Drawers into position.

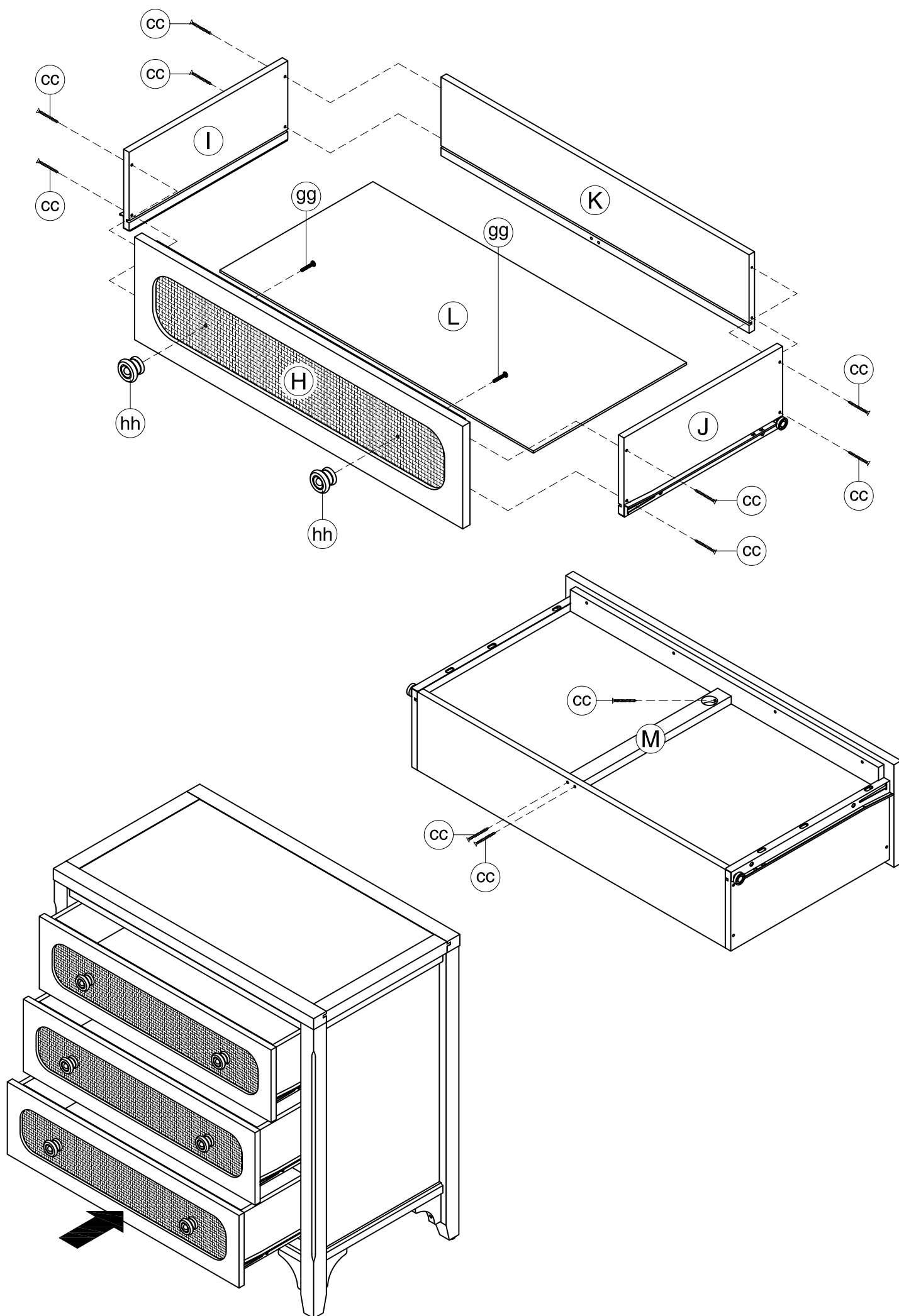

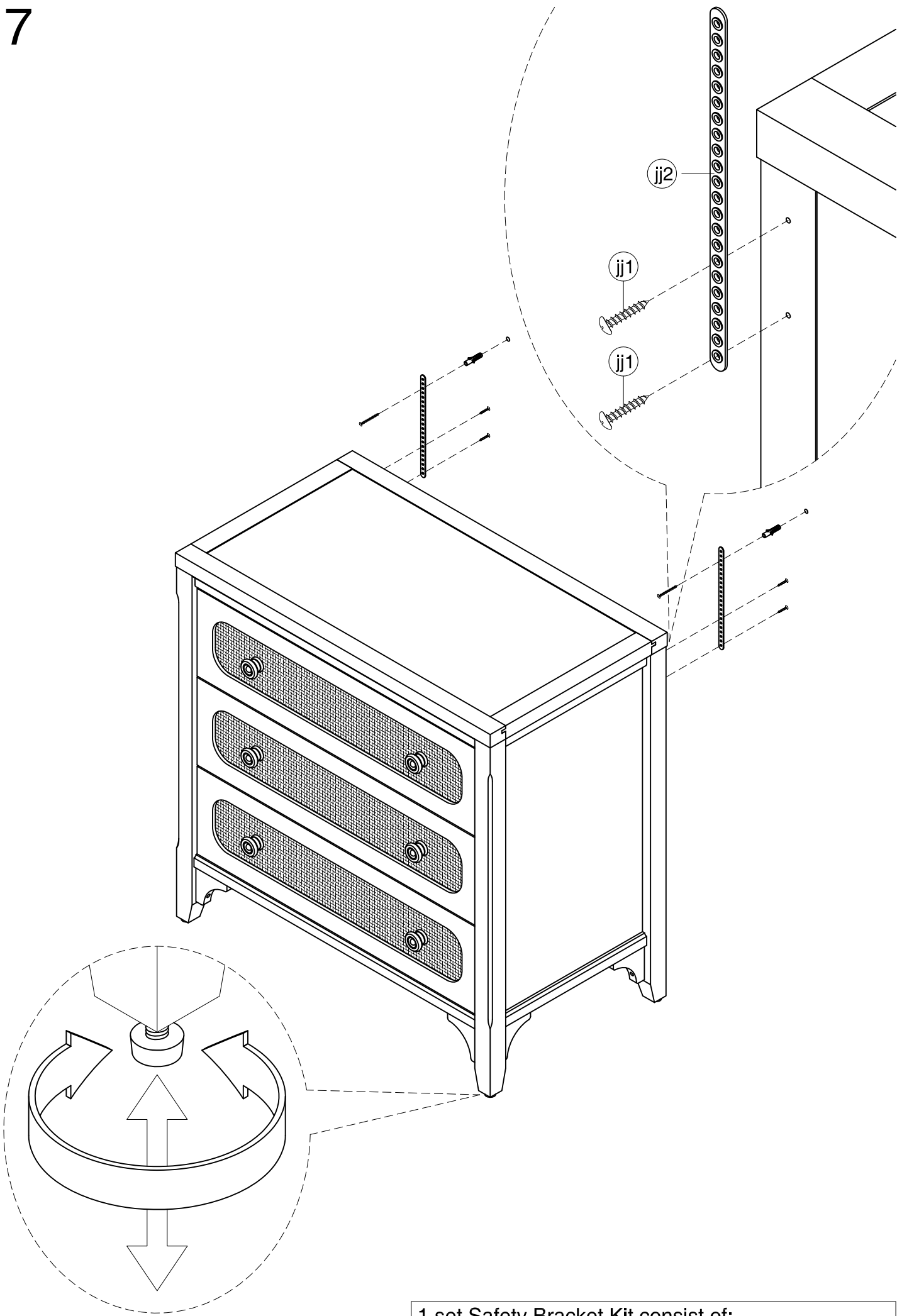

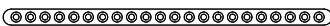
1 set Safety Bracket Kit consist of:			
jj1		Wood Screw	2 pcs
jj2		Plastic Restraint	1 pc

- * Attach Plastic Restraint (jj2) to back of unit using Screws (jj1).
- * Attach Plastic Restraint (jj2) that has already attached to unit to wall using wall screw & anchor (not provided).
- * Adjust the adjuster that has already been assembled to the legs to stabilize your unit.

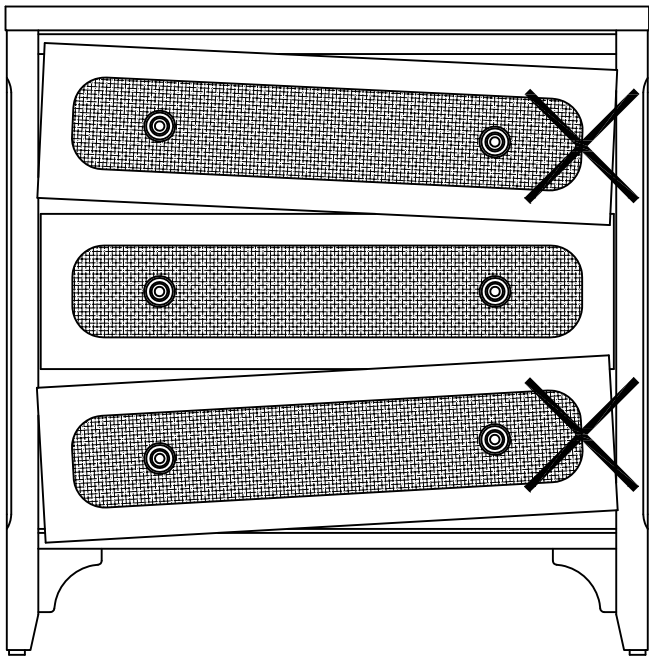

I. IF THE DRAWER DOES NOT ALIGN

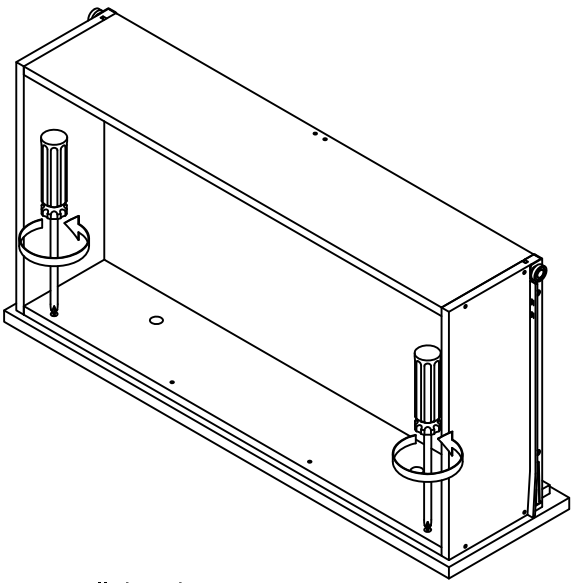

Loosen slightly the upper screws.

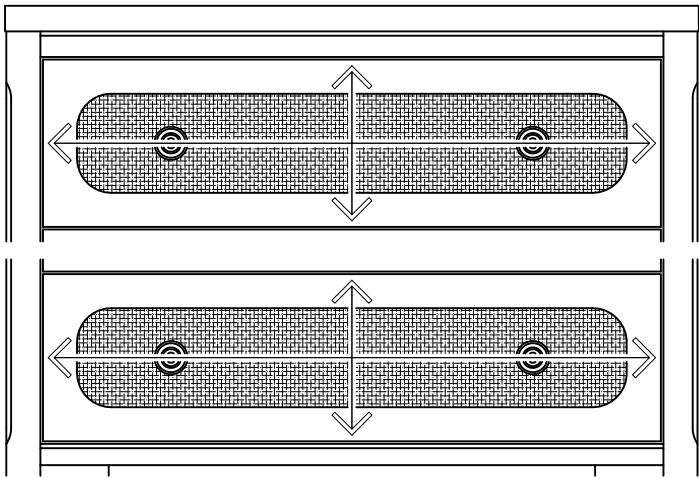

II. IF THE DRAWER ALREADY ALIGNS

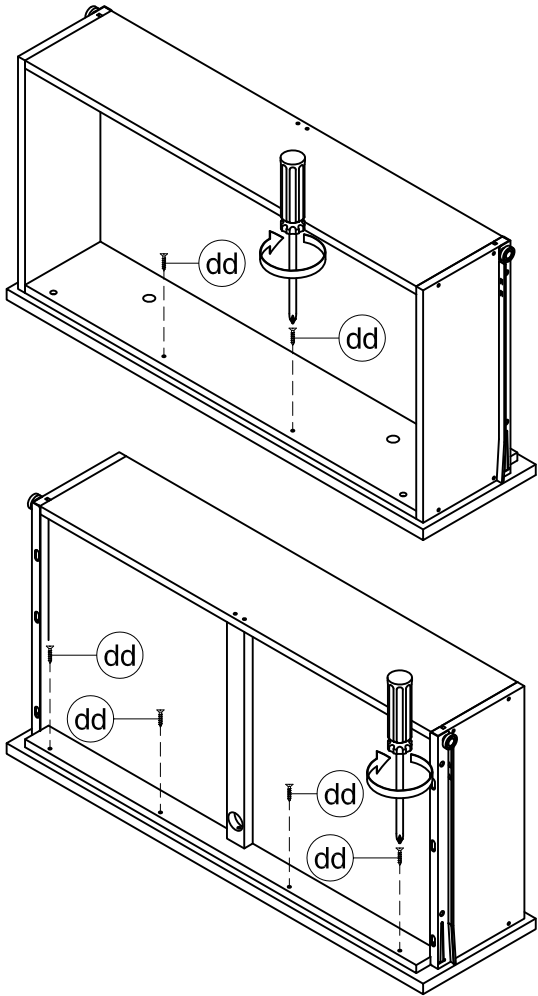

Pull out drawer slowly. Lock the drawer front panel into position using Wood Screws (dd).

Insert the drawer into the main body, then adjust the drawer front panel left or right and up or down, until the drawer gaps look proportional.

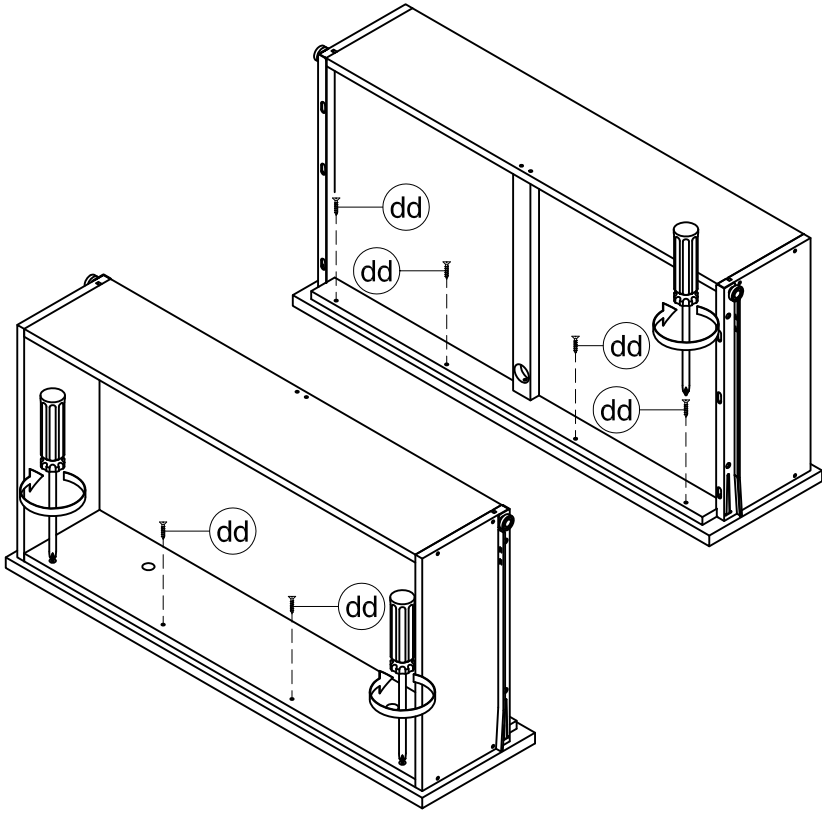

Pull the drawer open slowly and tighten the upper screws. Make sure the front panel does not move and lock the drawer front panel into position using Wood Screws (dd).