

# CASEWOOD STUDIOS

## LURIAN DRESSER 6 DRAWER TRADITIONAL

---

FT-STB07-02-04-01 / FT-STB07-02-04-02

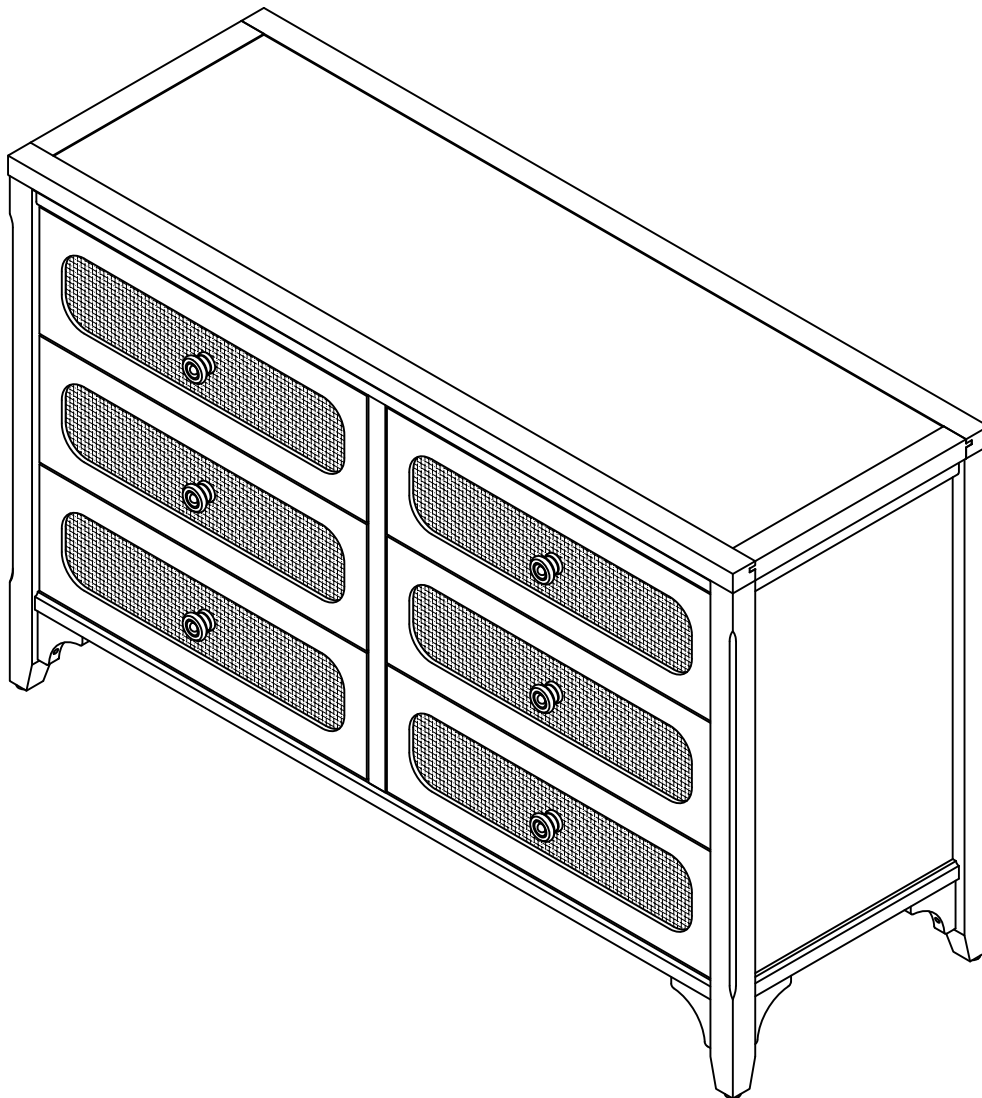

---

## ASSEMBLY INSTRUCTIONS

## Introduction

Please read all instructions first.

All you need to assemble your unit is a Phillips screwdriver.

Before you begin, take some time to check all parts against the hardware and parts list on the next pages.

Please place all parts on a soft cloth or carpet to prevent scratching during assembly.



To avoid collapse or injury, DO NOT sit, stand or climb on this unit. DO NOT stack heavy objects on this unit.  
NEVER put a TV on this product.  
NEVER allow children to climb or hang on drawers.

## Care and Maintenance

Clean with a soft damp cloth.

Should a deep scratch or gouge occur, we recommend touch up with a matching paint or stain available in most hardware stores.

# PARTS & HARDWARES

|  |  |  |  |
|--|--|--|--|
| aa = 5 pcs<br>+1 Extra<br>Wood Screw Ø8x1 1/4" | bb = 2 pcs<br>+1 Extra<br>Wood Screw Ø6x1 1/4" | cc = 66 pcs<br>+1 Extra<br>Wood Screw 1 1/4" | dd = 36 pcs<br>+1 Extra<br>Wood Screw 3/4" |
| ee = 25 pcs<br>+1 Extra<br>Camlock Bolt        | ff = 25 pcs<br>+1 Extra<br>Camlock             | gg = 6 pcs<br>Handle Bolt                    | hh = 6 pcs<br>Handle                       |
| ii = 4 pcs<br>+1 Extra<br>Dowel                | jj = 2 sets<br>Safety Bracket Kit              | Tool Required (Not Included)                 |  |

- A. TOP ASSEMBLY

B. LEFT ASSEMBLY

C. RIGHT ASSEMBLY

D. DIVIDER

E. TOP RAIL

F. BOTTOM RAIL

G. BACK PANEL
- 1X H. DRAWER FRONT

1X I. DRAWER LEFT

1X J. DRAWER RIGHT

1X K. DRAWER BACK

1X L. DRAWER BASE

1X M. DRAWER SUPPORT

2X
- 6X

6X

6X

6X

6X

6X

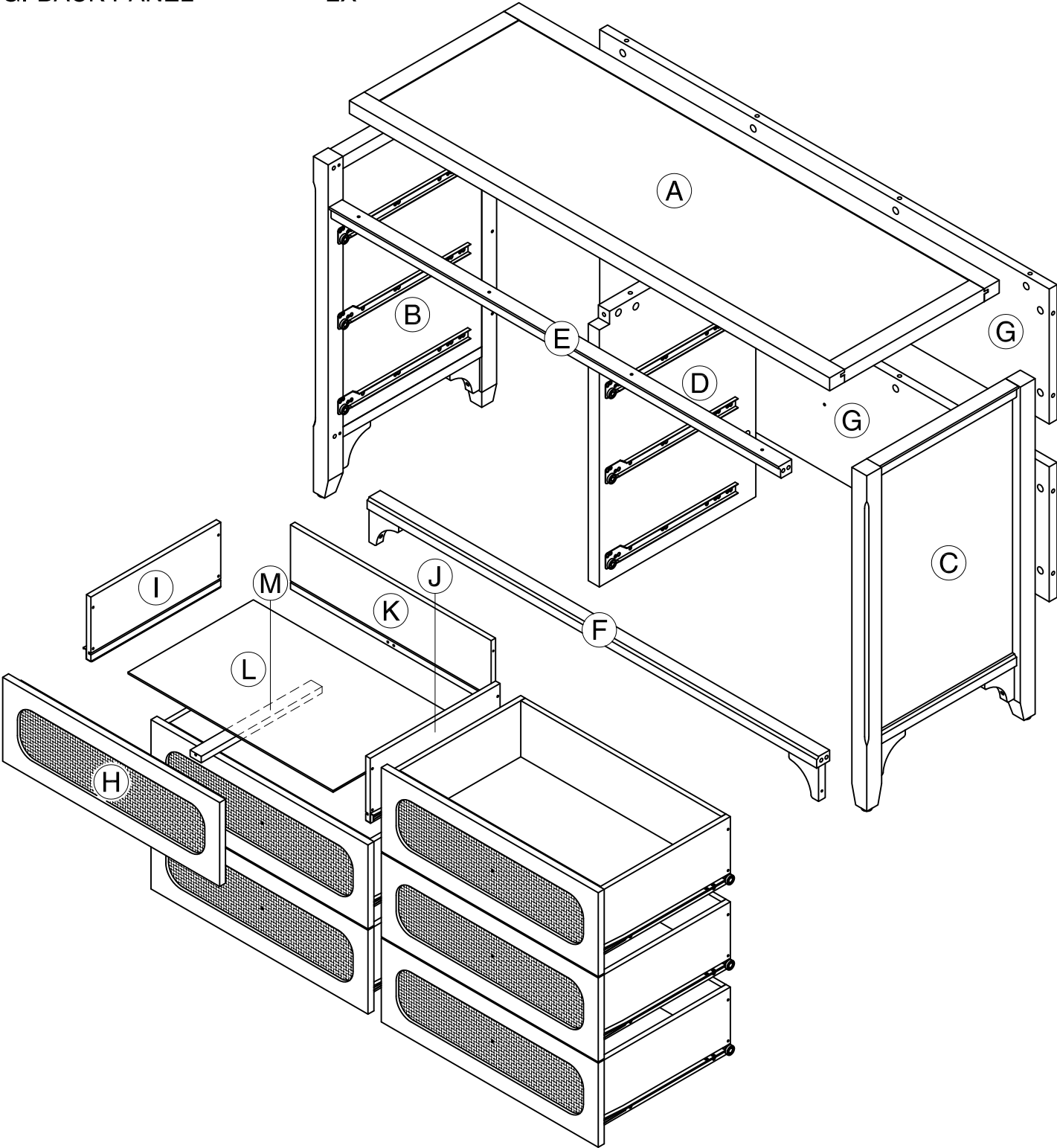

# 1

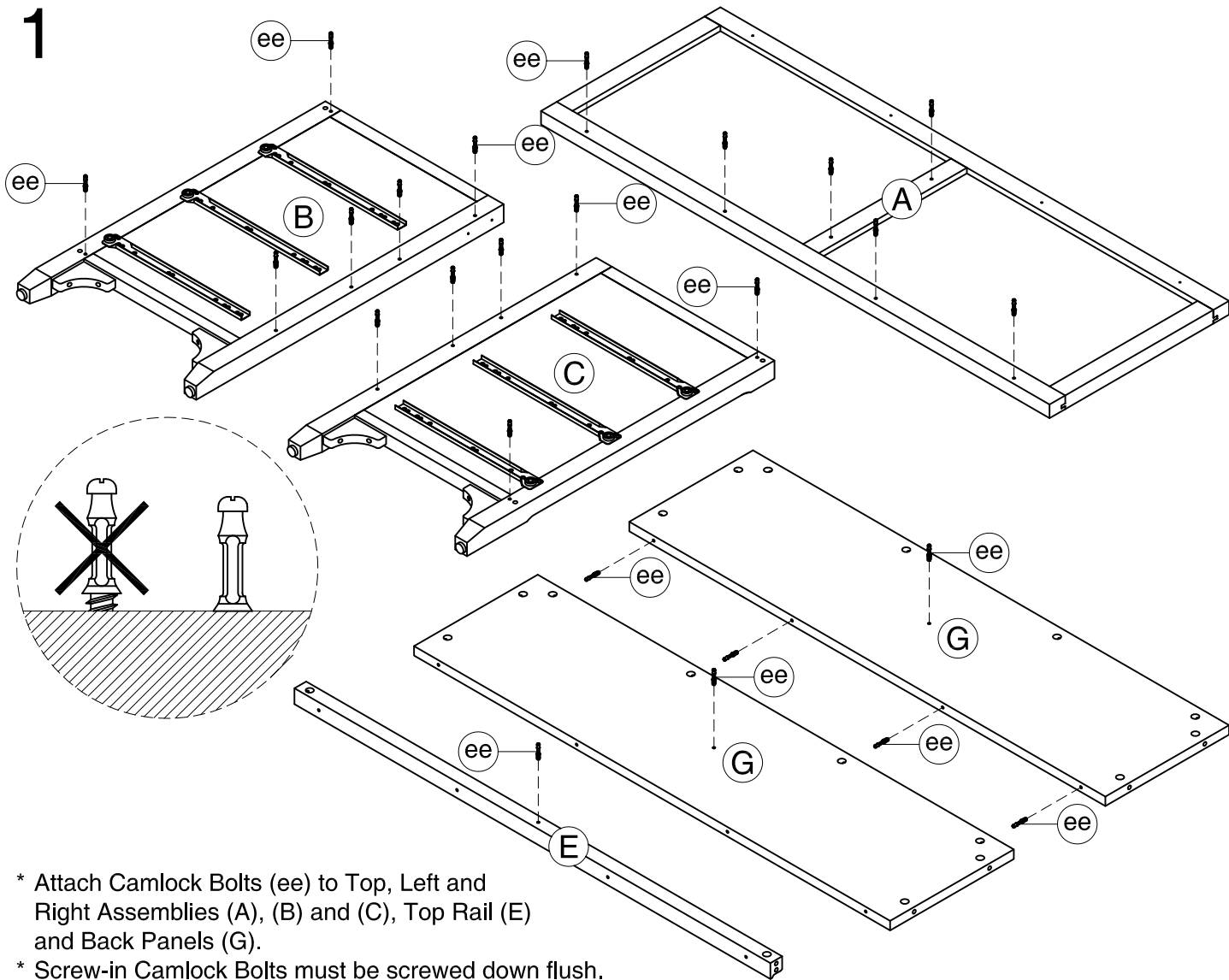

# 2

Join Back Panels (G) using Camlock (ff).

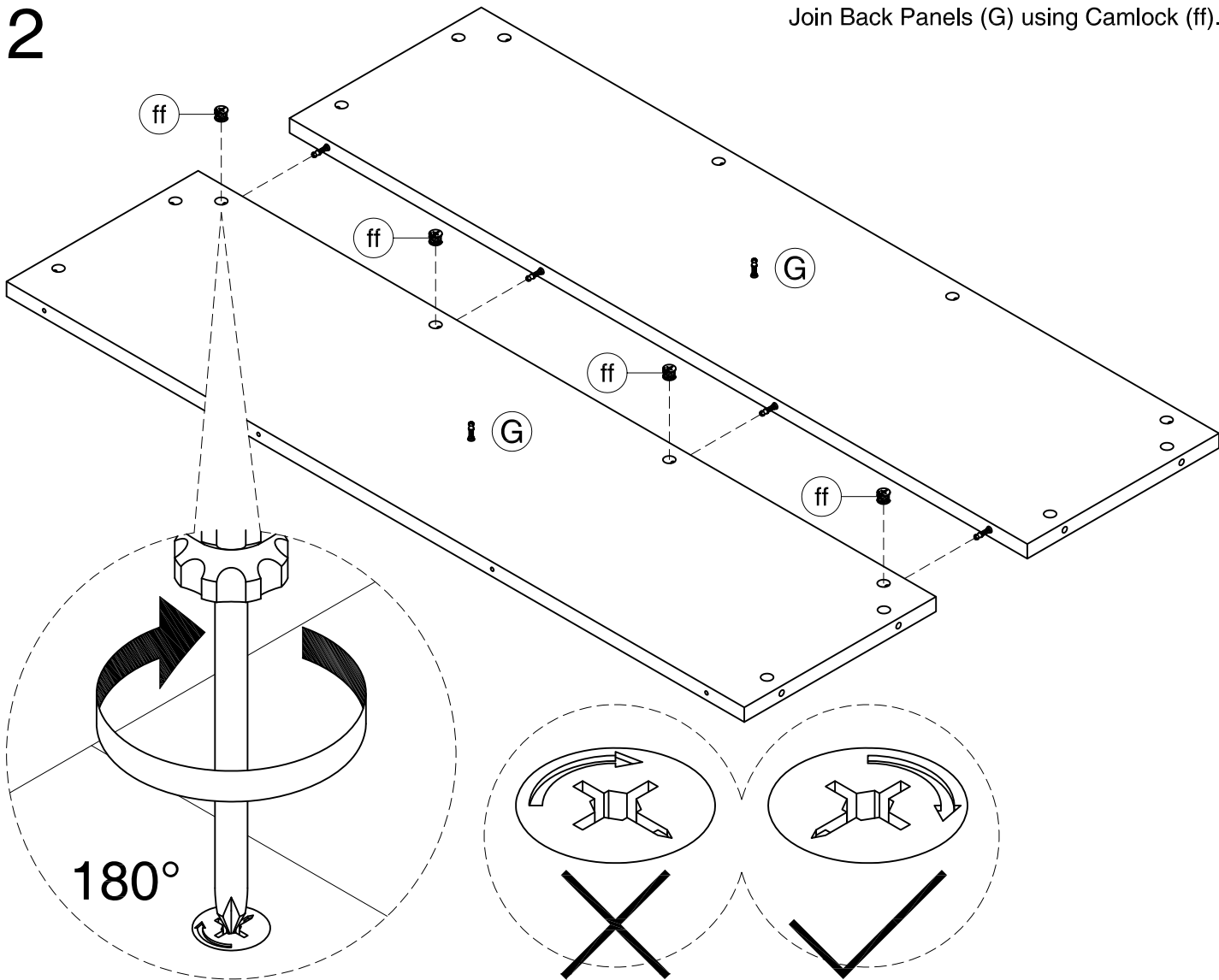

# 3

- \* Attach Top Rail (E) and Back Panels (G) to Divider (D) using Camlocks (ff).
- \* Attach Bottom Rail (F) to Divider (D) using Wood Screw (aa).

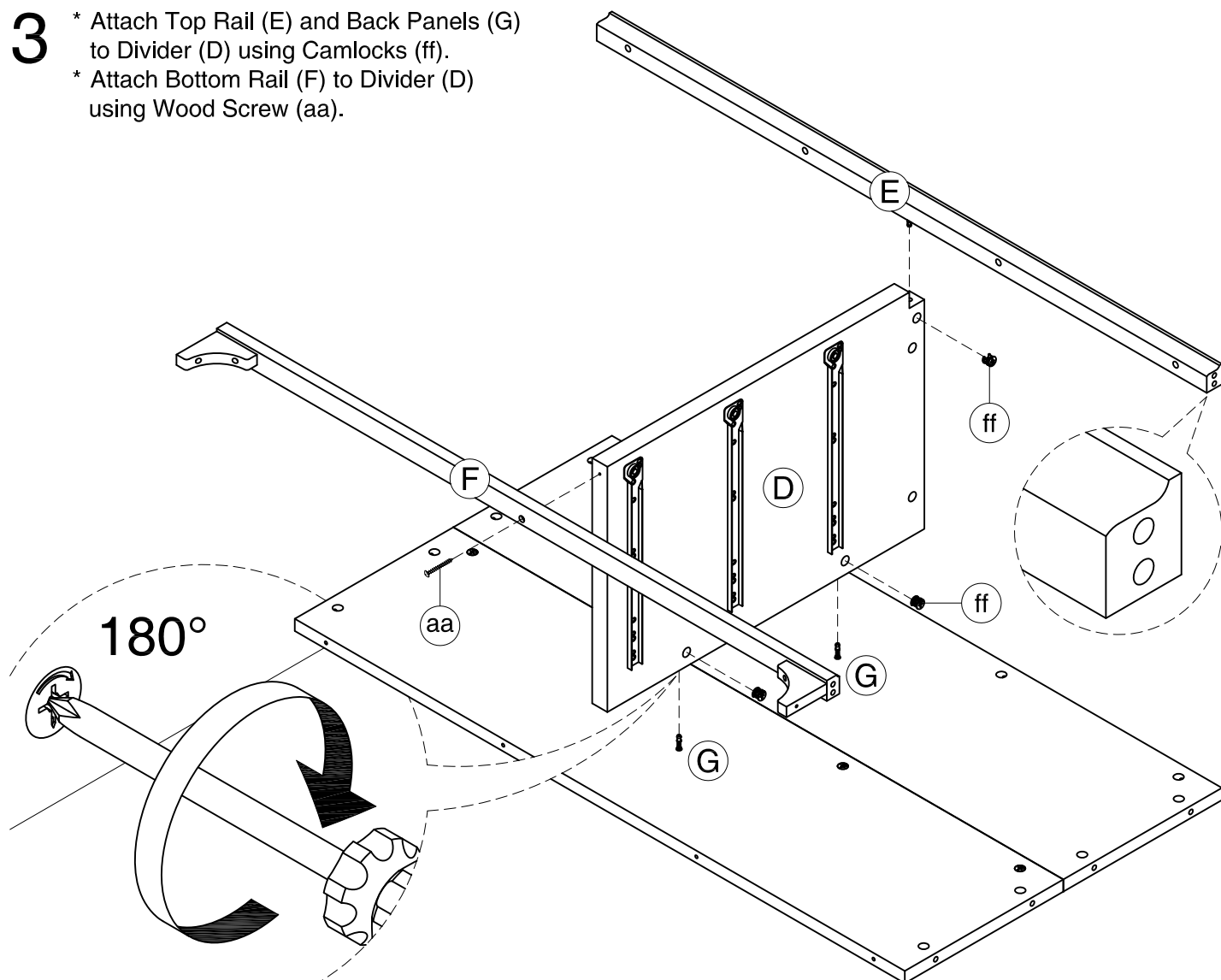

# 4

Attach Left and Right Assemblies (B) and (C) to unit using Wood Screws (bb), Camlocks (ff) and Dowels (ii).

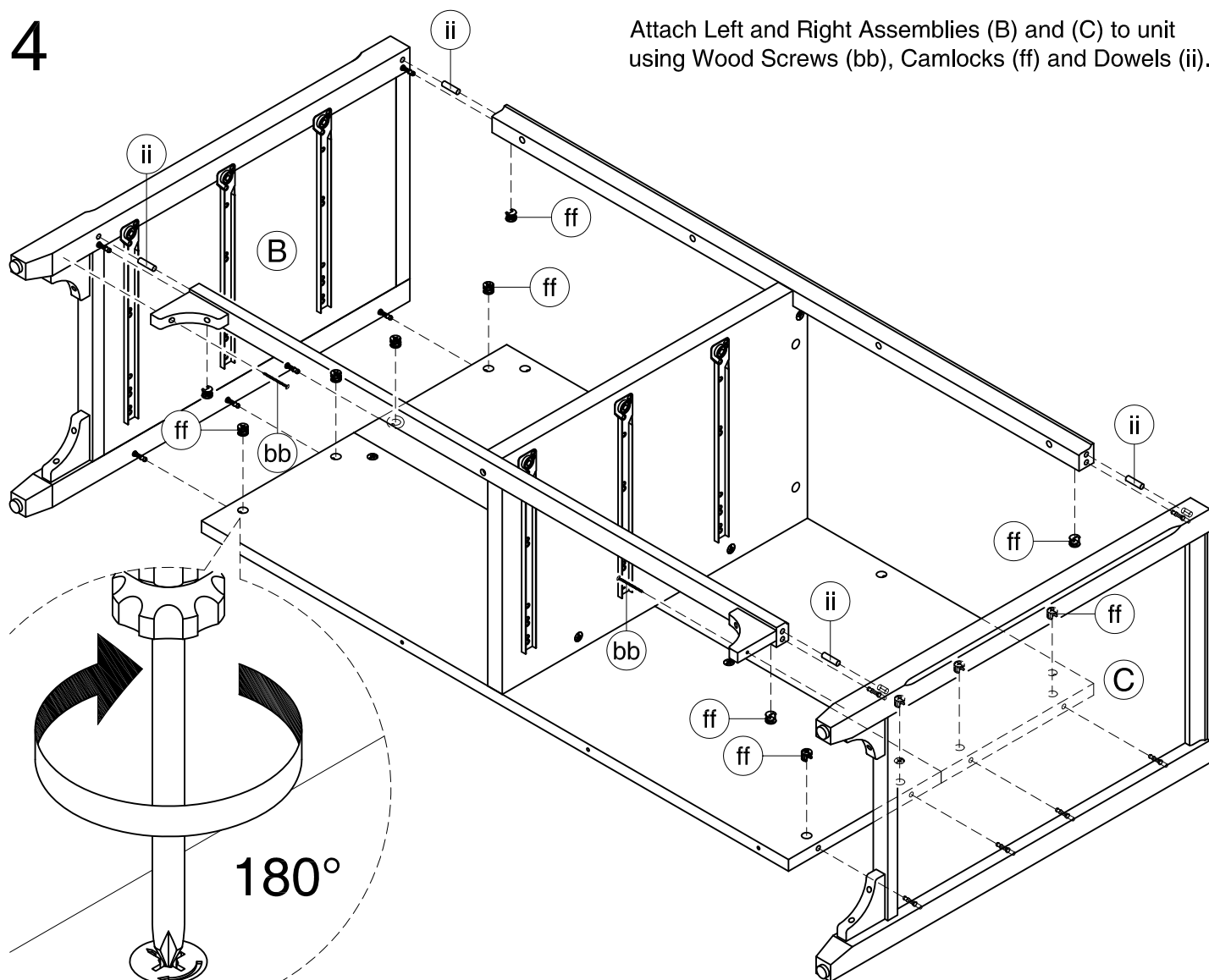

# 5

Attach Top Assembly (A) to unit using Wood Screws (aa) and Camlocks (ff).

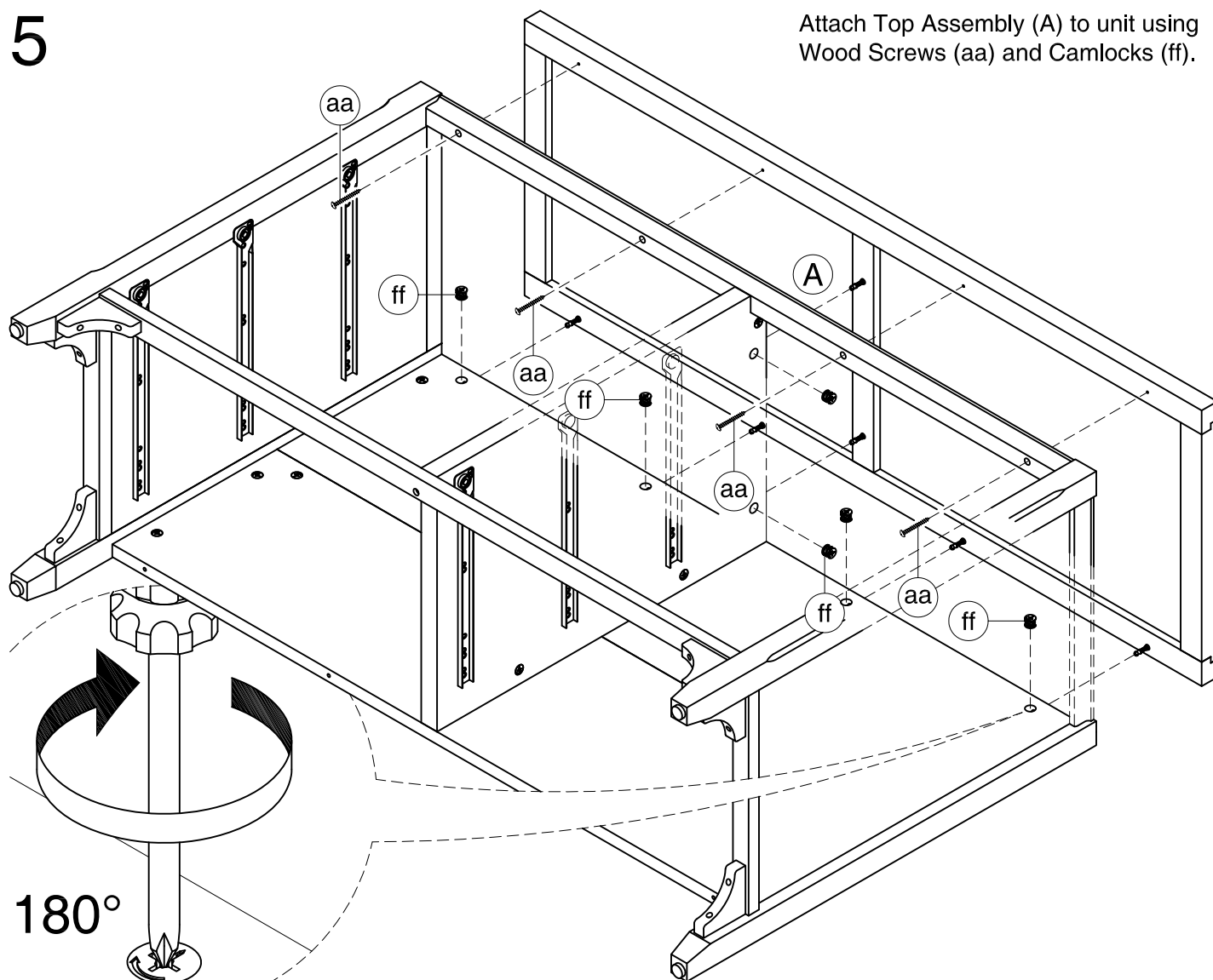

# 6

- \* Attach Handle (hh) to Drawer Front (H) using Handle Bolt (gg).
- \* Attach Drawer Left and Right (I) and (J) to Drawer Back (K) using Wood Screw (cc).
- \* Slide Drawer Base (L) into the groove.
- \* Attach Drawer Front (H) to Drawer Left and Right (I) and (J) using Wood Screw (cc).
- \* Attach Drawer Support (M) to the bottom side of drawers using Wood Screw (cc).
- \* Do the same step to the next drawers.

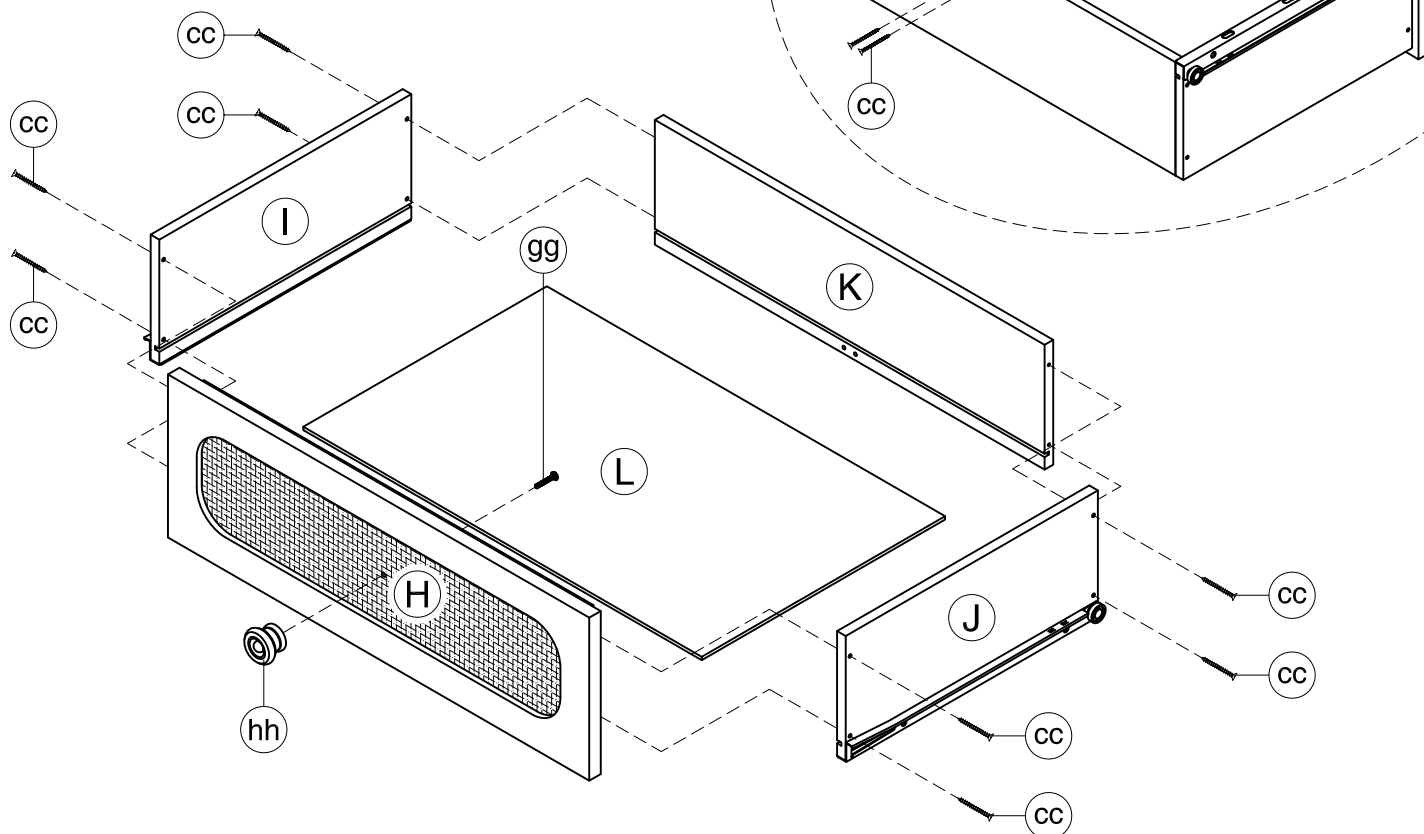



7

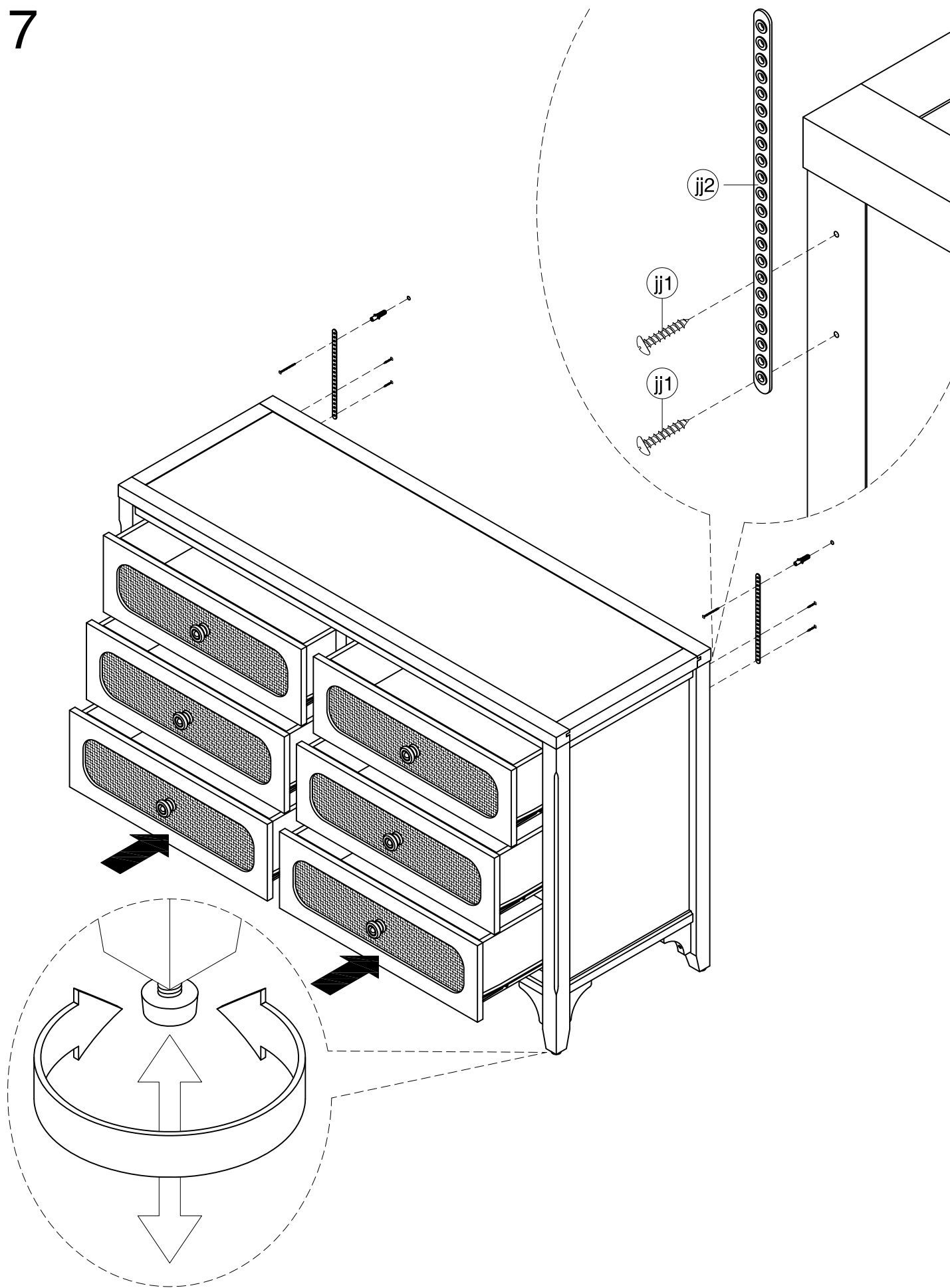

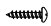
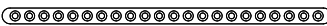
|                                      |  |                   |       |
|--------------------------------------|--|-------------------|-------|
| 1 set Safety Bracket Kit consist of: |  |                   |       |
| jj1                                  |  | Wood Screw        | 2 pcs |
| jj2                                  |  | Plastic Restraint | 1 pc  |

- \* Slide Drawers into position.
- \* Attach Plastic Restraint (jj2) to back of unit using Screws (jj1).
- \* Attach Plastic Restraint (jj2) that has already attached to unit to wall using wall screw & anchor (not provided).
- \* Adjust the adjuster that has already been assembled to the legs to stabilize your unit.

**I. IF THE DRAWER DOES NOT ALIGN**

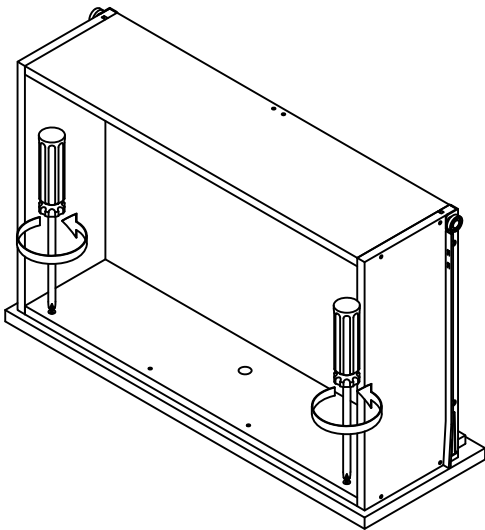
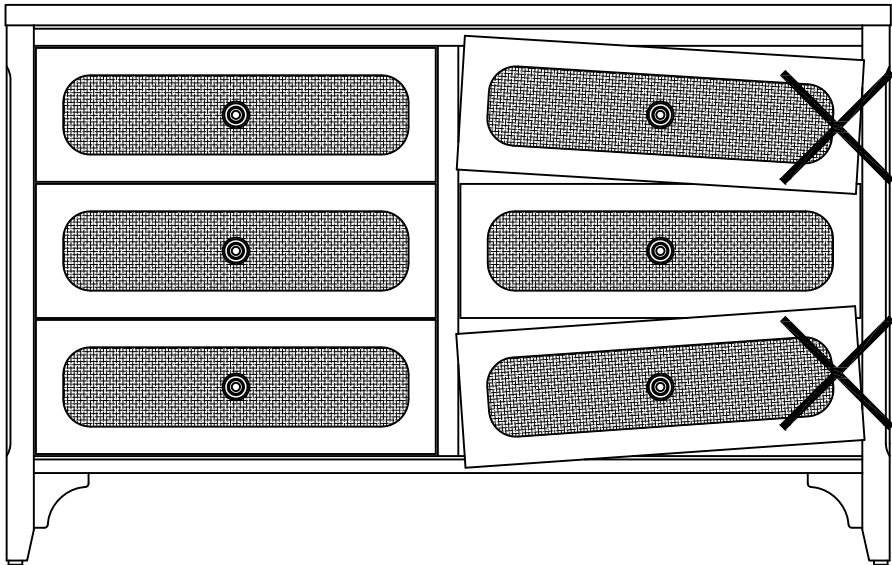

Loosen slightly the upper screws.

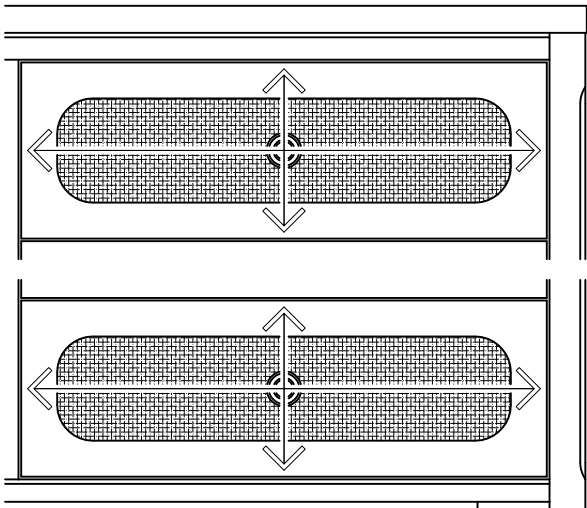

**II. IF THE DRAWER ALREADY ALIGNS**

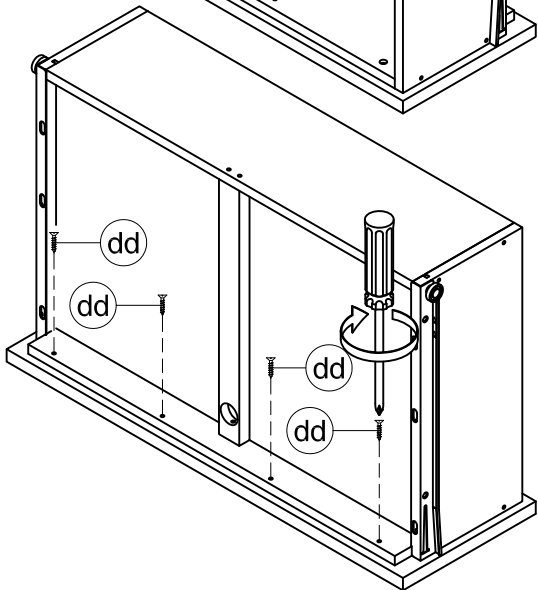
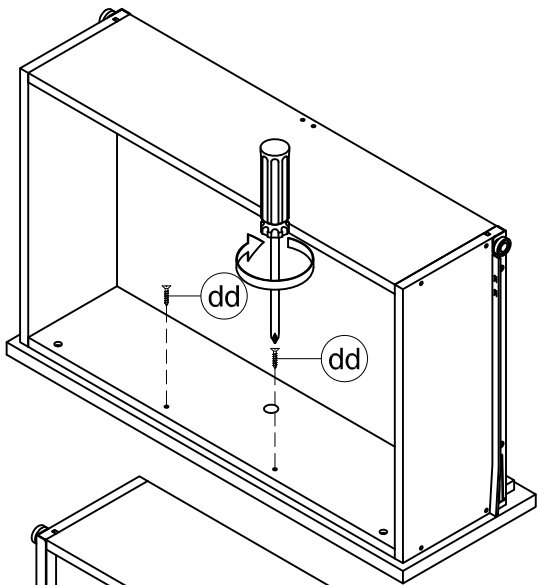

Pull out drawer slowly. Lock the drawer front panel into position using Wood Screws (dd).

Insert the drawer into the main body, then adjust the drawer front panel left or right and up or down, until the drawer gaps look proportional.

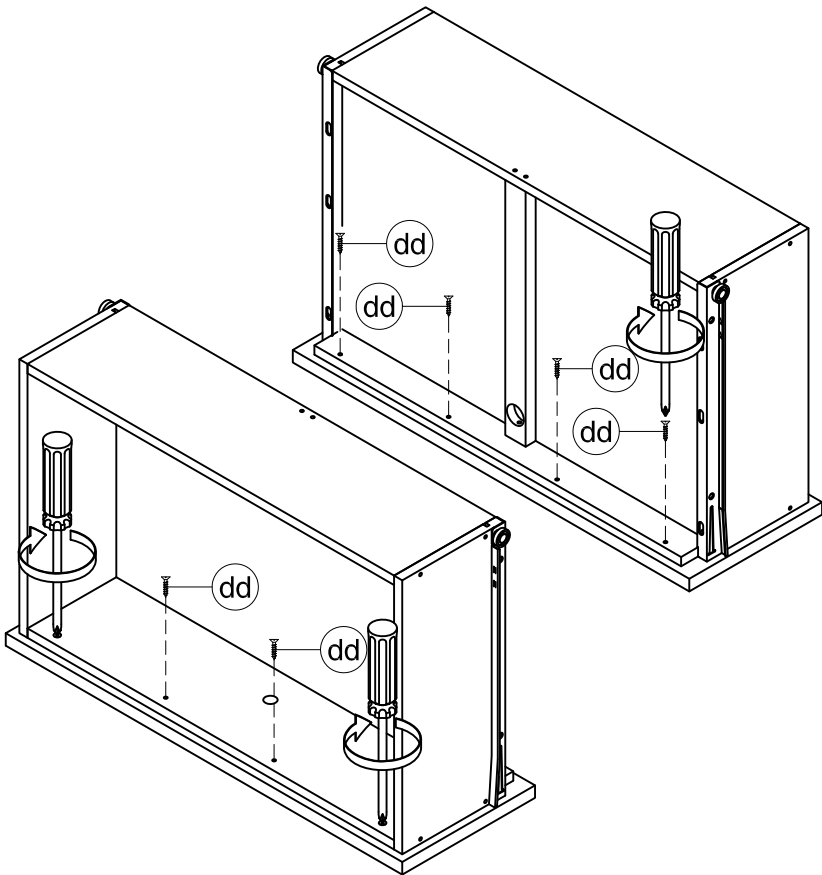

Pull the drawer open slowly and tighten the upper screws. Make sure the front panel does not move and lock the drawer front panel into position using Wood Screws (dd).