

CASEWOOD STUDIOS

LIORA SQUARE COFFEE TABLE WITH SHELF RATTAN

FT-STB01-00-08-01 / FT-STB01-00-08-02

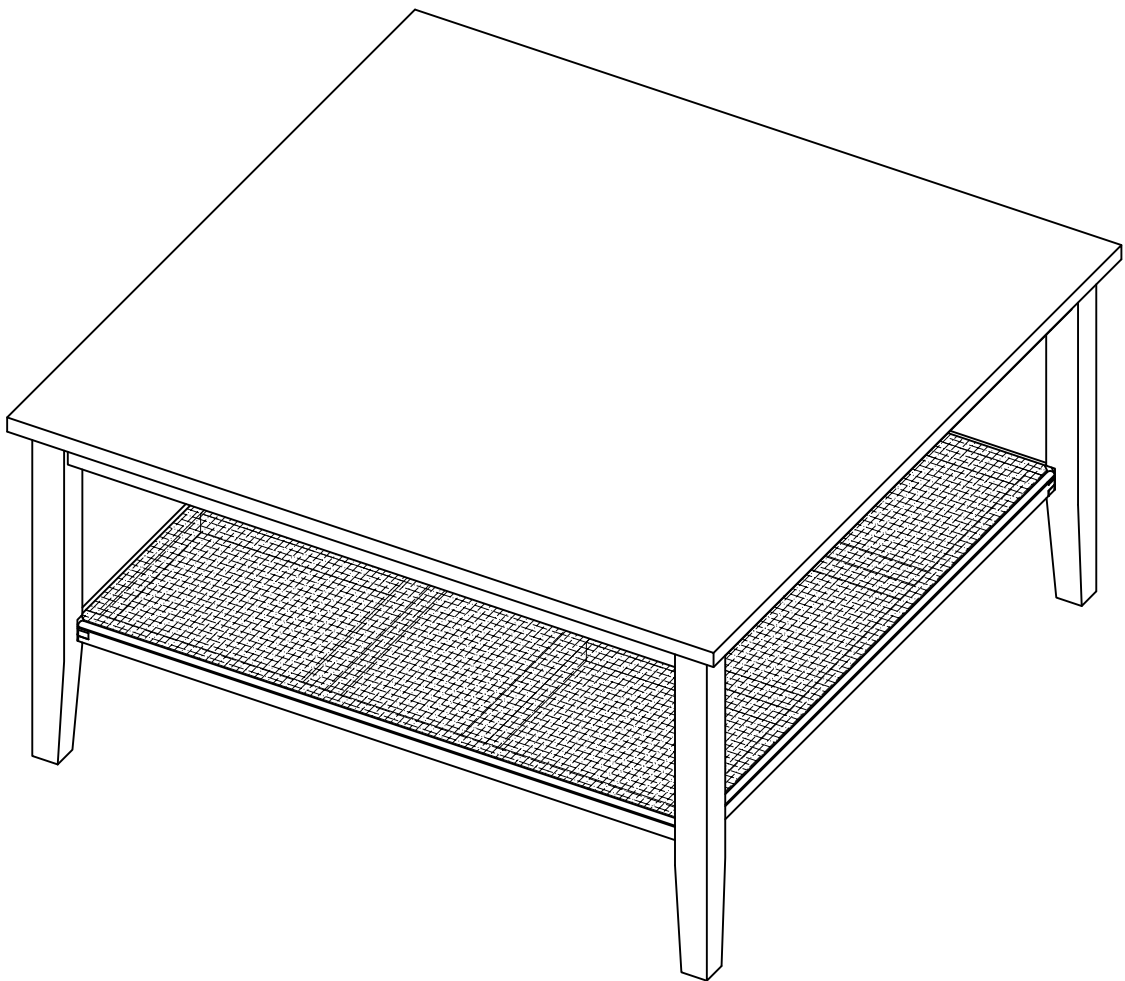

ASSEMBLY INSTRUCTIONS

Introduction

Please read all instructions first.

All you need to assemble your unit is a Phillips screwdriver.

Before you begin, take some time to check all parts against the hardware and parts list on the next pages.

Please place all parts on a soft cloth or carpet to prevent scratching during assembly.



To avoid collapse or injury, DO NOT sit, stand or climb on this unit. DO NOT stack heavy objects on this unit.
NEVER put a TV on this product.
NEVER allow children to climb or hang on shelves.

Care and Maintenance

Clean with a soft damp cloth.

Should a deep scratch or gouge occur, we recommend touch up with a matching paint or stain available in most hardware stores.

PARTS & HARDWARES

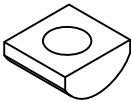
aa = 4 pcs +1 Extra	Long Bolt	bb = 8 pcs +1 Extra	Short Bolt	cc = 12 pcs +1 Extra	Spring Washer
					
dd = 4 pcs +1 Extra	Spacer	ee = 1 pc	Allen Wrench		
					

- A. TOP ASSEMBLY

1X
- B. LEG

4X
- C. SHELF ASSEMBLY

1X

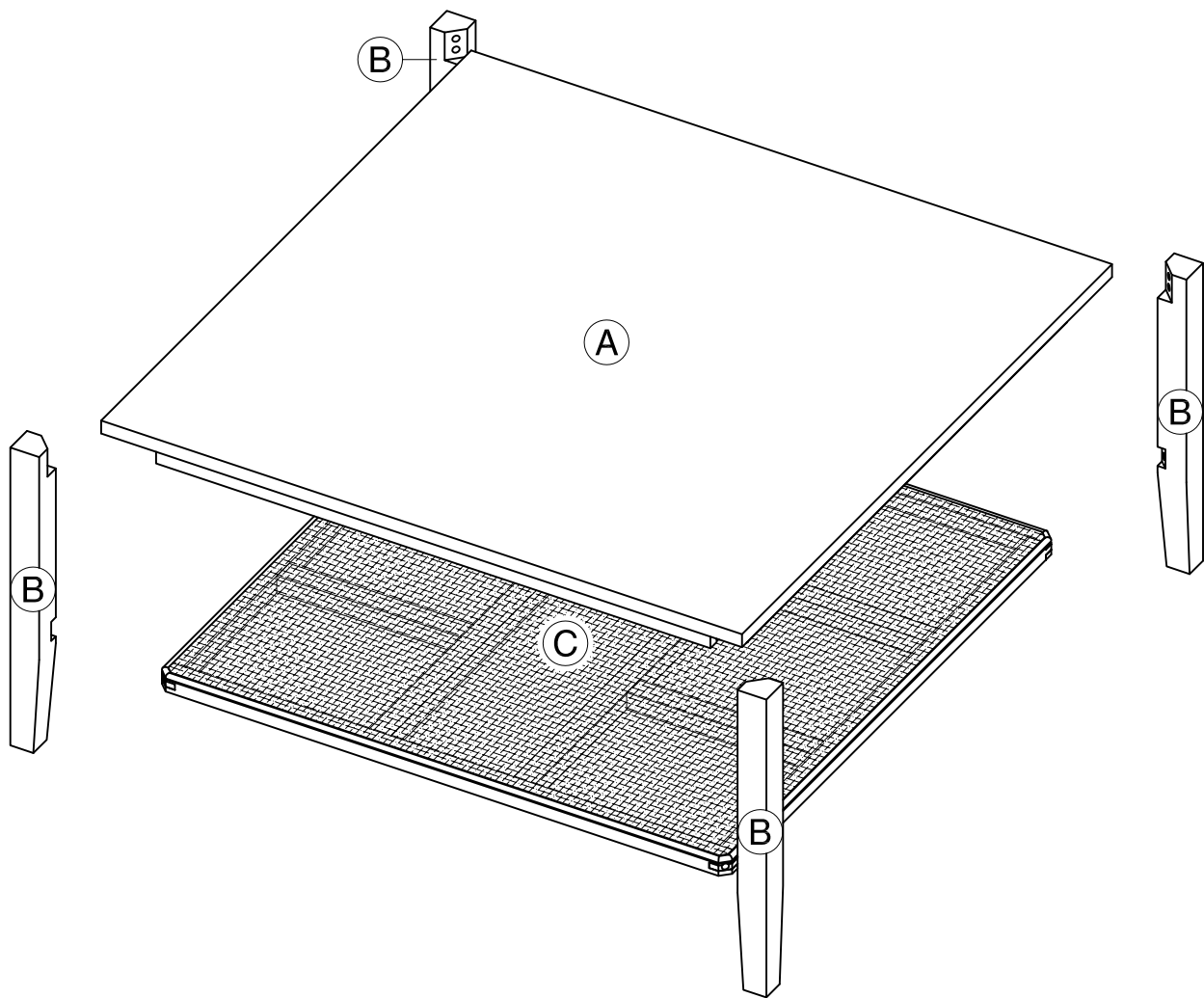

1

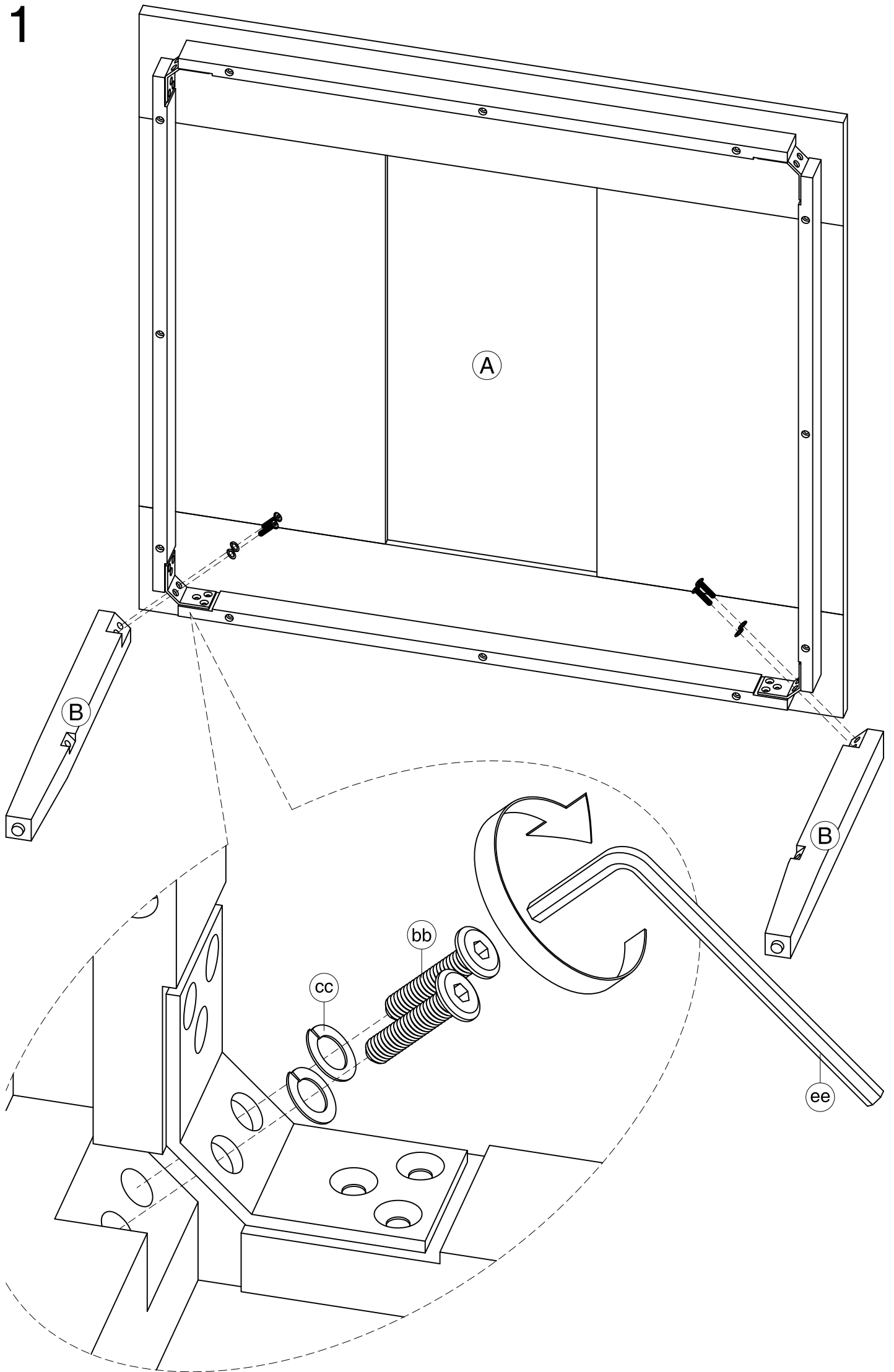

- * Attach Legs (B) to Top Assembly (A) using Short Bolts (bb) and Spring Washers (cc).
- * Tighten Short Bolts (bb) using Allen Wrench (ee).

2

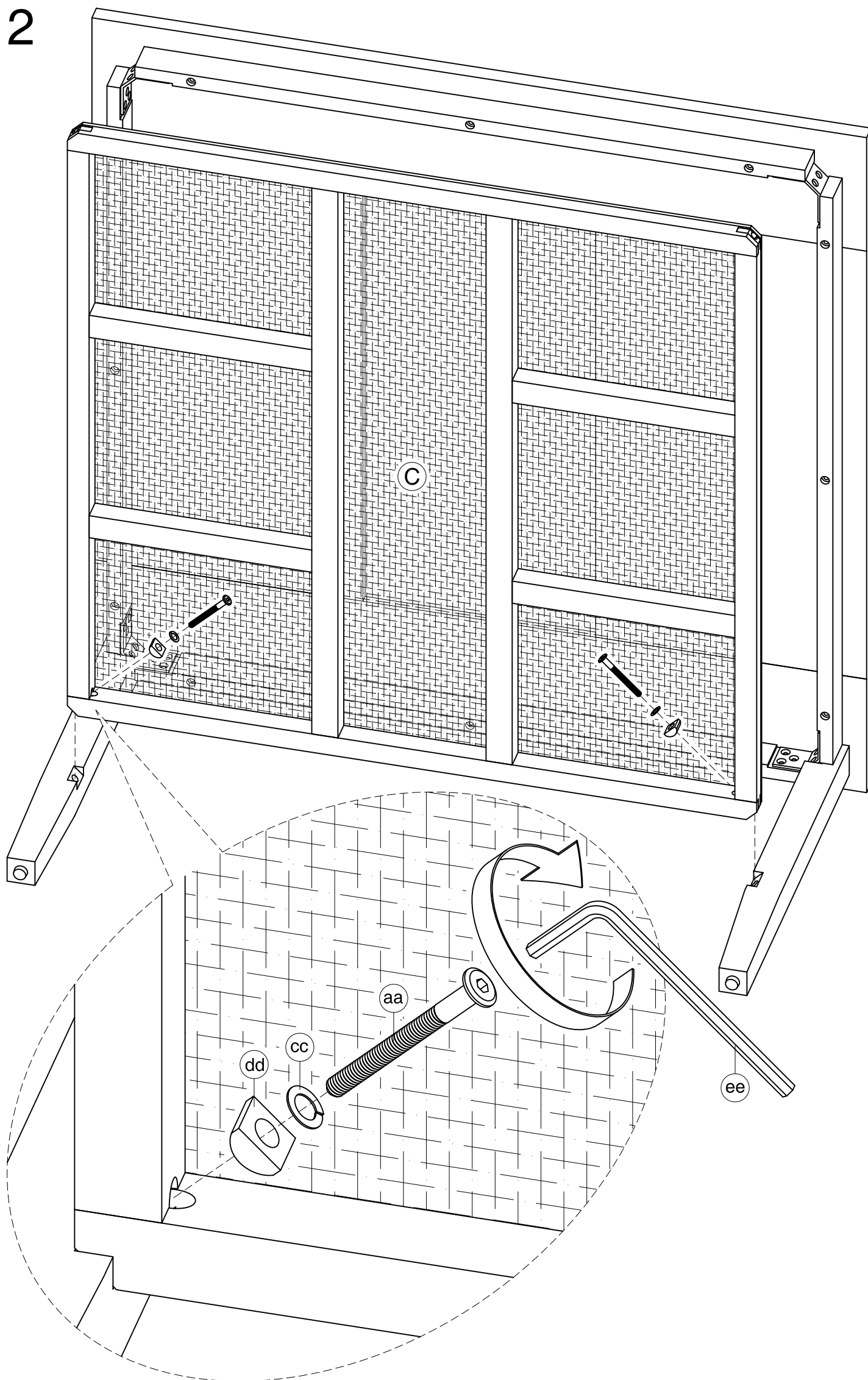

- * Attach Shelf Assembly (C) to unit using Long Bolts (aa), Spring Washers (cc) and Spacers (dd).
- * Tighten Long Bolts (aa) using Allen Wrench (ee).

3

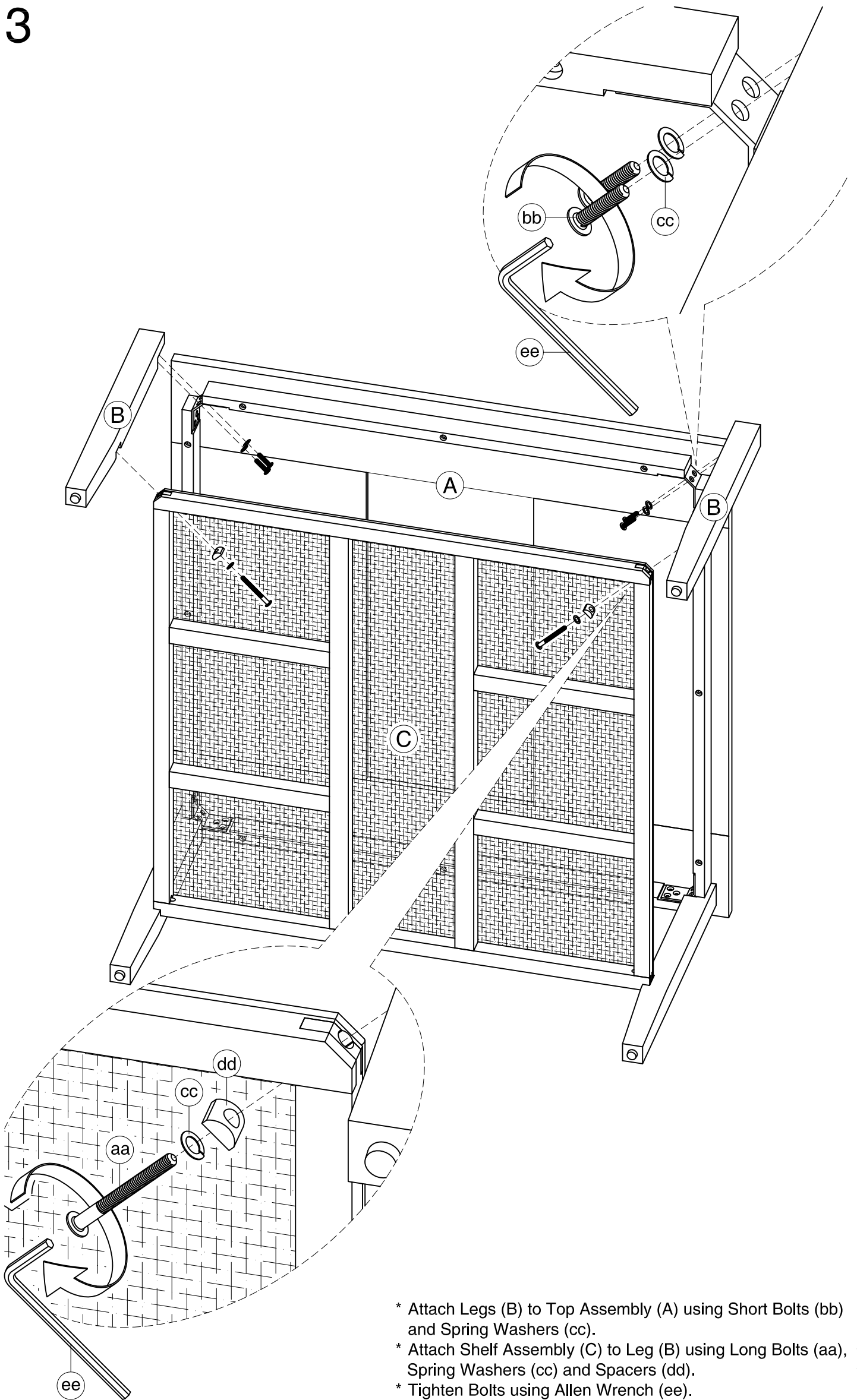

- * Attach Legs (B) to Top Assembly (A) using Short Bolts (bb) and Spring Washers (cc).
- * Attach Shelf Assembly (C) to Leg (B) using Long Bolts (aa), Spring Washers (cc) and Spacers (dd).
- * Tighten Bolts using Allen Wrench (ee).

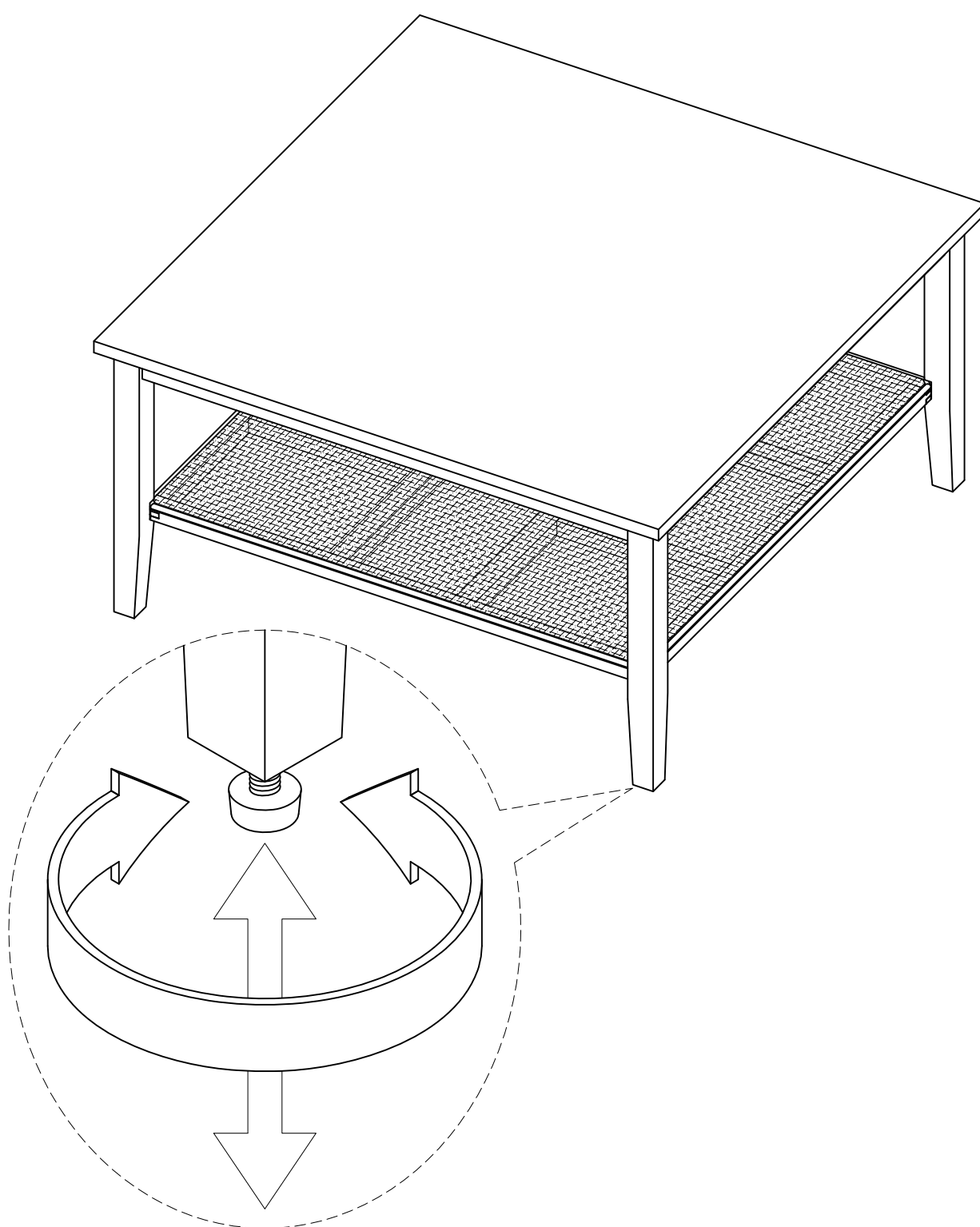

* Adjust the adjuster that has already been assembled to the legs to stabilize your unit.